



Unisub Framed Ornaments

Unisub Sublimation and Assembly Tip Sheet

MATERIALS NEEDED:

- Unisub Ornament Frame
- Unisub Bare Ornament Insert
- Printed Transfer and Scissors
- Sublimation Printer (RIP Printing Software)
- Small Swing Away Heat Press set to 385° F (Heat Gloves and Heat Tape)
- Blowout Paper
- Cloth for Cleaning and All-Purpose Cleaner



INSTRUCTIONS

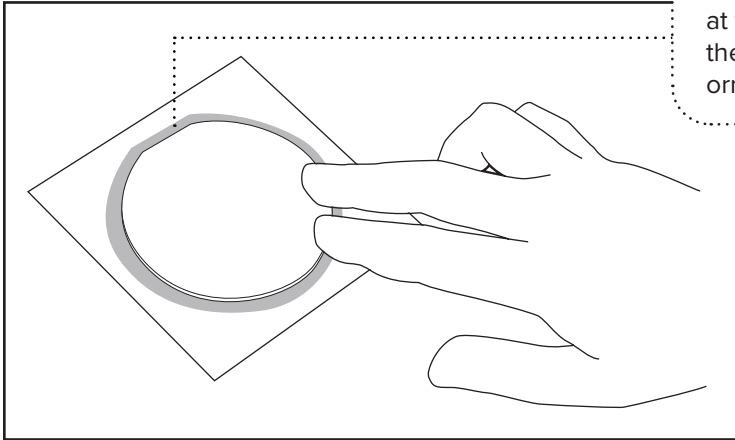

Extra Tip: The Round Framed Ornament has a special flat feature at the top that aids in alignment. Line up the insert and transfer so the flat area is at the top of the design. After sublimation, line up the flat area of the insert with the flat area of the ornament frame for a perfect fit!

Product	Temperature	One at a time	Several at a time
Framed Ornament Inserts	385° F	40-50 seconds	1:00-1:10

Step 1: First, clean the ornament insert. Next, line it up and center on transfer. Tape to the transfer.

Step 2: With coated side facing up, press ornament insert(s) at 385° F following the times in the chart above. Time may vary based on equipment.

Step 3: Remove the transfer and let insert cool.

ASSEMBLY

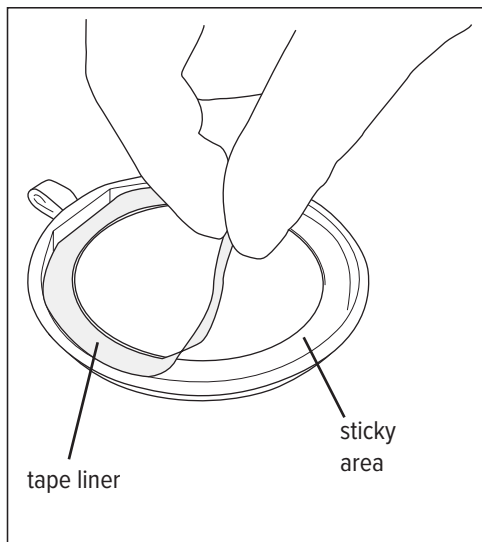

Step 1: Remove tape liner from back of ornament frame.

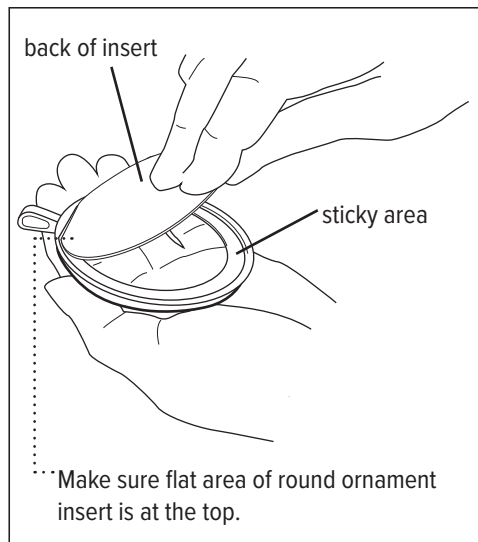

Step 2: Make sure top of decorated insert is correctly aligned with top of ornament frame. The insert should be oriented so the image will show through the front of the frame.

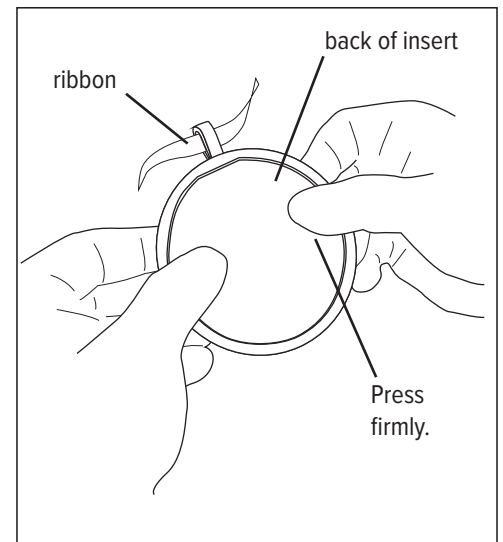

Step 3: Press firmly for 15-20 seconds to adhere insert to frame. Add ribbon and enjoy!